

**PRO NAUTIC MATERIAIS NAUTICOS LTDA.**  
 PRAÇA JOÃO BERGMANN, 115  
 PORTO ALEGRE, RS  
 TEL. 51 3062557



**ÂNCORA FOLDING INOX**  
 Stainless Steel Folding Anchor



Art No.	Size (kgs)
SM010101	0.7
SM010102	1.5
SM010103	2.5
SM010104	3.2
SM010105	4
SM010106	6
SM010107	7
SM010108	8
SM010110	10
SM010112	12
SM010116	16

**ÂNCORA FOLDING GALVANIZ.**  
 Folding Anchor Galvanized

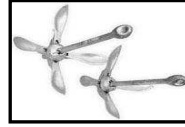

Art No.	Size (kgs)
SM010201	0.7
SM010202	1.5
SM010203	2.5
SM010204	3.2
SM010205	4
SM010206	6
SM010208	8
SM010210	10
SM010212	12
SM010215	15

**ÂNCORA BRUCE INOX**  
 Stainless Steel Bruce Anchor



Art No.	Size (kgs)
SM010301	1
SM010302	2
SM010303	2.5
SM010304	3
SM010305	5
SM010308	7.5
SM010310	10
SM010315	15
SM010320	20
SM010325	25
SM010330	30
SM010350	50

**ÂNCORA BRUCE GALVANIZ.**  
 Bruce Anchor Galvanized

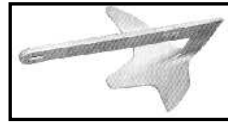

Art No.	Size (kgs)
SM010402	2
SM010405	5
SM010408	7.5
SM010410	10
SM010415	15
SM010420	20
SM010425	25
SM010430	30
SM010450	50

**ÂNCORA ARADO GALVANIZADA**  
 Plow Anchor Hot Dip Galvanized



Art No.	Size (mm)
SM010605	5
SM010607	7
SM010609	9
SM010612	12
SM010615	15
SM010616	16
SM010620	20
SM010627	27

### ÂNCORA ARADO INOX

Stainless Steel Plow Anchor

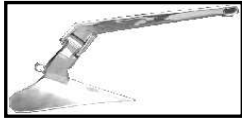

Art No.	Size (kgs)
SM010502	2
SM010505	5
SM010507	7
SM010509	9
SM010510	10
SM010512	12
SM010515	15
SM010516	16
SM010520	20
SM010522	22
SM010527	27

### ÂNCORA DANFORTH INOX

Danforth Stype Anchor AISI316



Art No.	Size (kgs)
SM010702	2
SM010703	3
SM010704	3.4
SM010705	4.5
SM010706	6
SM010708	7.5
SM010710	10
SM010712	12
SM010716	16
SM010720	20
SM010725	25
SM010730	30

### ÂNCORA COGUMELO

Mushroom Anchor HDG



Art No.	Size (lbs)
SM010901	25
SM010902	50
SM010903	75
SM010904	100
SM010905	150
SM010906	200
SM010907	250
SM010908	300
SM010909	350
SM010910	400
SM010911	450
SM010912	500

### ANODOS

Fornecemos anodos de acordo com sua necessidades para volumes pré-estipulados.



**ZINC CHEMICAL COMPOSITION**

U.S. -Mil-A-1800 1 K
Al - 0,10 - 0,5%
Cd - 0,025 - 0,07%
Fe - 0,005% max
Cu - 0,005% max
Pb - 0,006% max
Others - 0,10% max
Zn - min 99,134%

**Electrochemical properties**

Efficiency: 95%
Potencial: -1.10V.Cu/CuSo.Ref.
Capacity: 780 amperes hours per Kg
Consumption: 11,2 Kgs per ampere year

**ALUMINIUM CHEMICAL**

Composition Al/Zn/In Alloy
Zn - min 4% / max 5%
In - min 0,015% / max 0,020%
Si - min 0,080% / max 0,120%
Fe - max 0,090%
Cu - max 0,003%
Others - 0,10% max
Al - Remainder

**Electrochemical properties**

Efficiency: 90%
Potencial: -1.05V.Ag/AgCl.Ref.
Capacity: 2700 amperes hours per Kg
Consumption: 3,27 Kgs per ampere year

**MAGNESIUM CHEMICAL**

Composition High Purity Alloy
Cu - 0,08%
Al - min 5,3% / max 6,7%
Si - max 0,3%
Fe - max 0,005%
Mn - max 0,25%
Ni - max 0,003%
Zn - min 2,5% / max 3,5%
Pb - 0,03%
Mg - Remainder

**Electrochemical properties**

Efficiency: 50%
Potencial: -1.05V.Ag/AgCl.Ref.
Capacity: 1230 amperes hours per Kg

**CUNHO HOLLOW BASE INOX**

Stainless Steel Hollow Base Cleat AISI316

Art No.	Size	Weight (lbs)
SM030104	4"	0.14
SM030105	5"	0.26
SM030106	6"	0.32
SM030107	8"	0.64
SM030108	8"(Heavy Duty)	0.78
SM030110	10"	0.96
SM030112	12"	1.98



**CUNHO FLUSH INOX**

Stainless Steel Flush Cleat AISI316

Art No.	Size	Weight (lbs)
SM030405	5"	0.85
SM030406	6"	1.2
SM030408	8"	2.6
SM030410	10"	4.7
SM030412	12"	10

**CUNHO SILHOUETTE INOX**

Stainless Steel Silhouette Cleat AISI316

Art No.	Size	Weight (lbs)
SM030306	6"	0.62
SM030308	8"	1.1
SM030310	10"	1.6

**CUNHO SURFBOARD INOX**

Stainless Steel Surfboard Cleat AISI316

Art No.	Size	Weight (lbs)
SM030204	4-5/16"	0.14
SM030206	6-5/16"	0.26
SM030208	8-1/4"	0.32

**CUNHO DEVY INOX**

Stainless Steel Devy Cleat AISI316

Art No.	Size	Weight (lbs)
SM030515	15"	6.2

**CUNHO INOX**

Stainless Steel Cleat AISI316

Art No.	Size	Weight (lbs)
SM030608	8-9/16"	1.65

**CUNHO INOX**

Stainless Steel Cleat AISI316

Art No.	Size	Weight (lbs)
SM030711	11-1/2"	1.52



**CUNHO INOX**

Stainless Steel Cleat AISI316

Art No.	Size
SM030810	10"
SM030812	12-3/8"

**CUNHO INOX**

Stainless Steel Cleat AISI316

Art No.	Size
SM031008	8"

**CUNHO COM PARAFUSO INOX**

Stainless Steel Cleat With Thread Stud AISI316

Art No.	Size
SM031108	8"
SM031110	10"
SM031112	12"
SM031115	15"

**CUNHO INOX**

Stainless Steel Cleat AISI316

Art No.	Size
SM031208	8"
SM031209	9"

**CUNHO INOX**

Stainless Steel Cleat AISI316

Art No.	Size
SM031308	8"
SM031309	9"
SM031312	12"
SM031315	15"

**CUNHO HUMPBACKED INOX**

Stainless Steel Humpbacked Cleat AISI316

Art No.	Size
SM031406	6"
SM031408	8"
SM031410	10"



**CUNHO INOX**

Stainless Steel Cleat AISI316

Art No.	Size
SM031504	4"

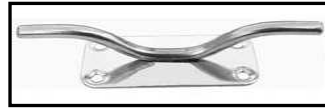
**CUNHO INOX**

Stainless Steel Lift Eye Cleat AISI316

Art No.	Size
SM031606	6"

**POSTE DE AMARRAÇÃO DE INOX**

Stainless Steel Bollard

Art No.	A (mm)	B (mm)	C (mm)	D (mm)	F (mm)	Weight (kgs)
SM031701	38x1.5	98	90	10	48	0.193
SM031702	50x2.0	120	100	12	55	0.361
SM031703	60x2.0	160	115	12	62	0.507
SM031704	76x2.5	210	150	14	85	0.872
SM031705	89x2.5	250	160	14	87	1.258
SM031706	102x2.5	280	180	16	98	1.952

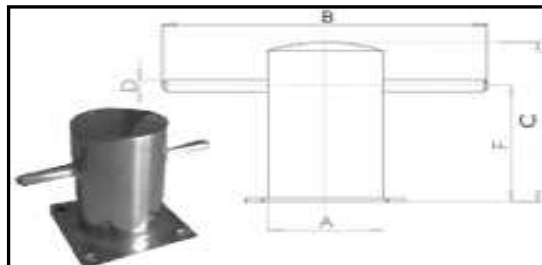
**POSTE DE AMARRAÇÃO DE INOX**

Stainless Steel Bollard

Art No.	A (mm)	B (mm)	C (mm)	D (mm)	BASE (mm)	F (mm)
SM031801	38x1.5	98	90	10	57x57x2.5	48
SM031802	50x2.0	120	100	12	72x72x2.5	55
SM031803	60x2.0	160	115	12	90x90x3.0	62
SM031804	76x2.5	210	150	14	110x110x3.5	85
SM031805	89x2.5	250	160	14	134x134x3.5	87
SM031806	102x2.5	280	180	16	148x148x4.0	98

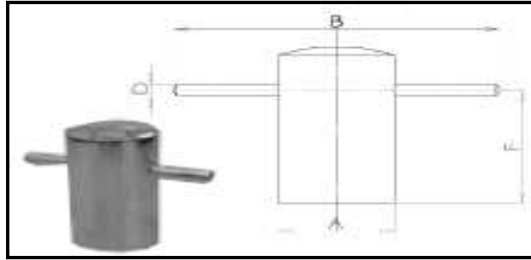

**POSTE DE AMARRAÇÃO ALTAMENTE POLIDO DE INOX**

Stainless Steel Bollard AISI316 Highly Polished

Art No.	A (mm)	Thickness
SM032001	477	10mm
SM032002	577	10mm

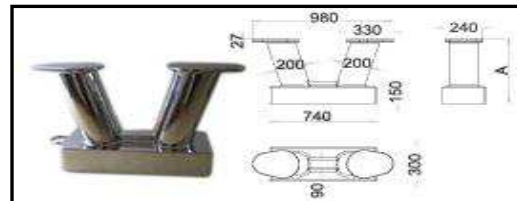

Obs. Pode ser produzido pelo projeto do cliente.

**POSTE DE AMARRAÇÃO ALTAMENTE POLIDO DE INOX**

Stainless Steel Bollard AISI316 Highly Polished

Art No.	Size
SM031901	6-1/2"
SM031902	8"
SM031903	9"
SM031904	10"
SM031905	12"



**POSTE DE AMARRAÇÃO PRODUZIDO PELO PROJETO DO CLIENTE**

Stainless Steel Bollard AISI316 Highly Polished Produced by customer's design



## GUIA PARA CABO DE AMARRAÇÃO

Stainless Steel Chocks AISI316

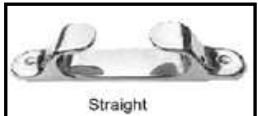
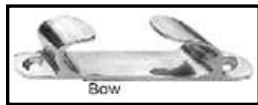

Art No.	Type	Size	Rope
SM040201	Straight	4-3/4"	3/4"
SM040202	Straight	6"	1"
SM040203	Bow	4"	5/8"
SM040204	Bow	6"	7/8"
SM040205	Skene	4"	3/4"
SM040206	Skene	6"	1"

## DOBRADIÇAS DE INOX

Hatch Hinge-A



Removable Pin Hinge



Hatch Hinge-B



Fast Pin Butt Hinge

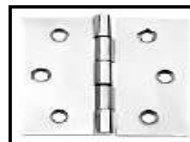

Hinge

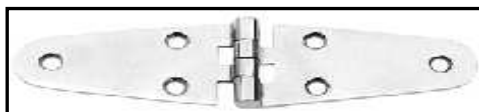

Art No.	Type	Size
SM040901	Hinge-A	3"
SM040902	Hinge-B	3-1/3"
SM040903	Hinge-B	3-1/2"
SM040904	Removable	1-5/8"x1-
SM040905	Removable	1-5/8"x2"
SM040906	Removable	2"x2"
SM040907	Removable	2-1/2"x2"
SM040908	Removable	2-1/2"x2-
SM040909	Removable	3"x3"
SM040910	Fast Pin	1-5/8"x1-
SM040911	Fast Pin	1-5/8"x2"

SM040912	Fast Pin	2"x2"
SM040913	Fast Pin	2"x2-1/2"
SM040914	Fast Pin	2-1/2"x2-
SM040915	Fast Pin	1-5/8"x3"
SM040916	Fast Pin	2"x3"
SM040917	Fast Pin	3"x3"
SM040918	Hinge	5-5/8"x1-

Strap Hinge:



Door Hinge-B:



Door Hinge-A:



Button Hinge:



Art No.	Type	Size	Weight (lbs)
SM040801	Strap	4"	0.19
SM040802	Hinge-A	3"	0.21
SM040803	Hinge-B	2"	0.26
SM040804	Button	1-1/2"	0.09
SM040805	Button	2"	0.12

Deck Hinge



Concave Deck Hinge



Deck Hinge w/ Release Pin



Concave w/ Release Pin



Deck Hinge Angle



Heavy Duty Deck Hinge

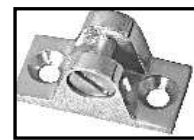

Side Deck Hinge-A



Side Deck Hinge-B



Art No.	Type	Size
SM041701	Deck Hinge	2-1/4"
SM041702	Concave Deck Hinge	2-1/4"
SM041703	Deck Hinge With Release Pin	2-1/4"
SM041704	Concave Deck Hinge With Pin	2-1/4"
SM041705	Deck Hinge 80°Angle	2-1/4"
SM041706	Heavy Duty Deck Hinge	2-1/4"
SM041707	Side Deck Hinge-A	2"
SM041708	Side Deck Hinge-B	2-13/16"

Crimple Instrument-A



Crimple Instrument-F



Art No.	Type	Size (LxWxH)
SM041801	Crimple Instrument-A	80x70x62mm
SM041806	Crimple Instrument-F	101x40x35mm

Top Cap



Top Slide



Hinge Top Slide-A



Hinge Top Slide-B



Top Slide-C



Top Slide-D



Blind Base



Art No.	Type	Size
SM041601	Top Cap	7/8"
SM041602	Top Cap	1"
SM041603	Top Slide	7/8"
SM041604	Top Slide	1"
SM041605	Hinge Top Slide-A	7/8"
SM041606	Hinge Top Slide-A	1"
SM041607	Hinge Top Slide-A	1-1/4"
SM041608	Hinge Top Slide-B	7/8"
SM041609	Top Slide-C	7/8"
SM041610	Top Slide-C	1"
SM041611	Top Slide-C	1-1/4"
SM041612	Top Slide-D	2-1/2"x2-1/2"
SM041613	Top Slide-D	1-3/4"
SM041614	Blind Base	1"

**PUXADORES DE INOX**

Lift Ring



Latch



Spring Lift Ring



Turning Lock Lift Handle



Eccentric Latch



Art No.	Type	Size
SM041001	Lift Ring	1-1/2"x1-1/2"
SM041002	Latch	62x44mm
SM041003	Spring Lift Ring	44x38mm
SM041004	Eccentric Latch	4-1/2"
SM041005	Turning Lock Lift Handle	2-5/8"x3-1/8"x4-3/8"

### DISTORCEDOR DE ÂNCORA DE INOX

Stainless Steel Swivel For Anchor Chain AISI316

Art No.	Type	For Chain	Length	Weight (lbs)
SM040101	Swivel	6-8mm	90mm	0.53
SM040102	Swivel	10-12mm	115mm	1
SM040103	Swivel-A	6-8mm	95mm	0.56
SM040104	Swivel-A	10-12mm	120mm	1.26
SM040105	Double	6-8mm	120mm	0.84
SM040106	Double	10-12mm	170mm	2.14

Swivel:



Swivel A:



Double:



### AGULHEIROS

Hose Deck



Hose Connector



Through Hull Outlets



Through Hull



Intake Strainer



Art No.	Type	Use	Size	Weight (lb)
SM040601	Hose Deck	Gas	1-1/2"	1
SM040602	Hose Deck	Diesel	1-1/2"	1
SM040603	Hose Deck	Water	1-1/2"	1
SM040604	Hose Deck	Water	1-1/2"	1
SM040605	Hose Deck	Gas	2"	1.37
SM040606	Hose Deck	Diesel	2"	1.37
SM040607	Connector		3/4"	0.56
SM040608	Connector		1"	0.68
SM040609	Connector		1-1/4"	0.76
SM040610	Connector		1-1/2"	1.06
SM040611	Connector		2"	1.06
SM040612	Outlets		3/4"	0.56
SM040613	Outlets		1"	0.68
SM040614	Outlets		1-1/4"	0.76
SM040615	Outlets		1-1/2"	1.06
SM040616	Outlets		2"	1.06
SM040617	Through		3/8"	0.18
SM040618	Through		1/2"	0.2
SM040619	Through		3/4"	0.35
SM040620	Through		1"	0.54
SM040621	Through		1-1/4"	0.73
SM040622	Through		1-1/2"	1
SM040623	Through		2"	1.5
SM040624	Intake		3/8"	0.4
SM040625	Intake		1/2"	0.58
SM040626	Intake		3/4"	0.89
SM040627	Intake		1"	1.03
SM040628	Intake		1-1/4"	1.28
SM040629	Intake		1-1/2"	1.81
SM040630	Intake		2"	2.3
SM040631	Intake		2-1/2"	5.5
SM040632	Intake		3"	7.27

**BASES CIRCULARES**

Weldable Base



Art No.	Type	Size
SM041201	Round	7/8"
SM041202	Round	1"
SM041203	Round	7/8"
SM041204	Rectangular	1"
SM041205	Rectangular	7/8"
SM041206	Rectangular	1"

## BASES

Stainless Steel Rail Base AISI316



Art No.	Type	Size
SM041101	Round Base	7/8"
SM041102	Round Base	1"
SM041103	Round Base	7/8"
SM041104	Round Base	1"
SM041105	Round Base	7/8"
SM041106	Round Base	1"
SM041107	Round Base	7/8"
SM041108	Round Base	1"
SM041109	Rectangular Base	7/8"
SM041110	Rectangular Base	1"
SM041111	Rectangular Base	7/8"
SM041112	Rectangular Base	1"
SM041113	Rectangular Base	7/8"
SM041114	Rectangular Base	1"
SM041115	Rectangular Base	7/8"
SM041116	Rectangular Base	1"
SM041117	Stanchion Base	1"

## ALÇAS INOX

Stainless Steel Pad Eye AISI316

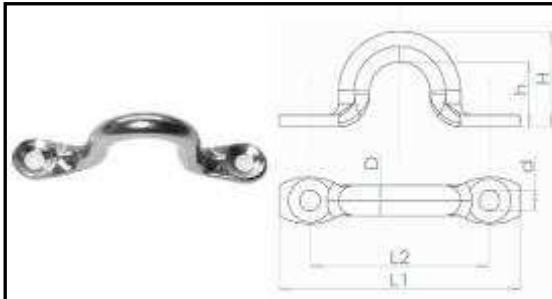

Art No.	D (mm)	L1 (mm)	L2 (mm)	H (mm)	h (mm)	d (mm)
SM020104	4	40	32	16	11	3.2
SM020105	5	50	40	16	13	4.2
SM020106	6	57	44	22	15	5.2
SM020108	8	63	47	25	17	5.2

## BASE RETANGULAR INOX

Stainless Steel Square Pad Eye AISI316

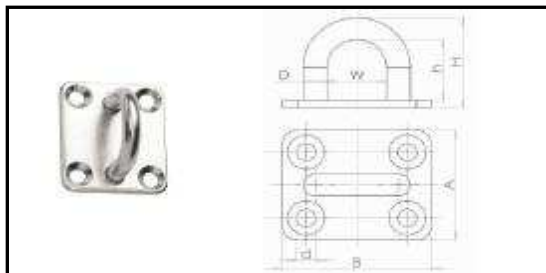

Art No.	D (MM)	A (MM)	B (MM)	H (MM)	h (MM)	w (MM)	d (MM)
SM020205	5	30	35	19	12	14	4.2
SM020206	6	35	40	26	17	18	5.2
SM020208	8	40	50	33	22	20	5.2

### BASE COM ANEL INOX

Stainless Steel Square Pad Eye With Ring AISI316

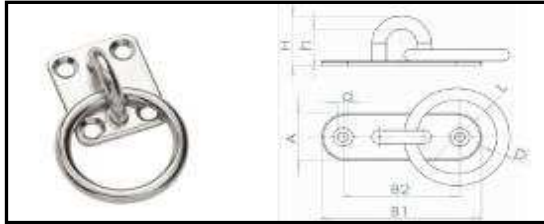

Art No.	D (MM)	A (MM)	B (MM)	H (MM)	d (MM)	I (MM)
SM020305	5	30	35	19	4.2	30
SM020306	6	35	40	26	5.2	40
SM020308	8	40	50	33	5.2	50

### BASE REDONDA INOX

Stainless Steel Round Pad Eye AISI316

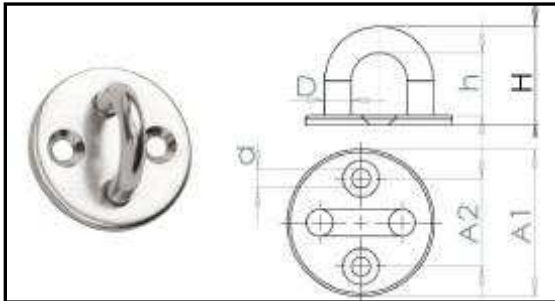

Art No.	D (MM)	A1 (MM)	A2 (MM)	h (MM)	H (MM)	d (MM)
SM020605	5	33	20	20	12	4.2
SM020606	6	40	23	26	17	4.2
SM020608	8	50	30	32	21	5.2

### BASE REDONDA COM ANEL INOX

Stainless Steel Round Pad Eye With Ring AISI316

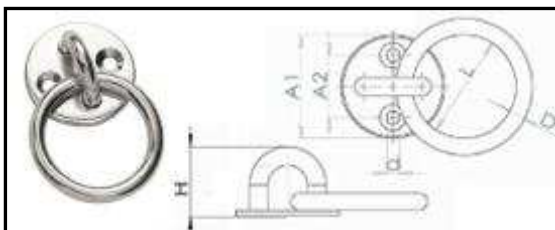

Art No.	D (MM)	A1 (MM)	A2 (MM)	H (MM)	d (MM)	L (MM)
SM020705	5	33	20	20	4.2	30
SM020706	6	40	23	26	4.2	40
SM020708	8	50	30	32	5.2	50

### BASE DIAMANTE INOX

Stainless Steel Diamond Pad Eye AISI316

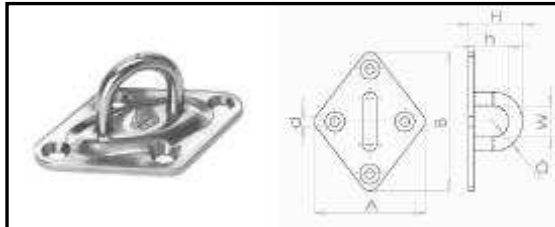

Art No.	D (MM)	A (MM)	B (MM)	H (MM)	h (MM)	w (MM)	d (MM)
SM020805	5	37	59	22	12	11	4.2
SM020806	6	50	64	26	15	15	4.2
SM020808	8	60	80	33	20	18	5.2

### BASE COM ANEL INOX

Stainless Steel Oblong Pad Eye With Ring AISI316

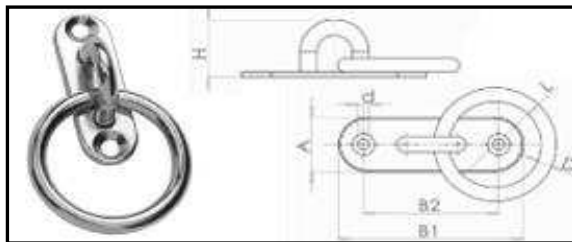

Art No.	D (MM)	A (MM)	B1 (MM)	B2 (MM)	H (MM)	d (MM)	l (MM)
SM020505	5	15	45	35.5	20	12	30
SM020506	6	20	60	46	25	17	40
SM020508	8	26	80	60	32	21	50
SM020509	9	32	100	73	38	26	60

### BASE INOX

Stainless Steel Oblong Pad Eye AISI316

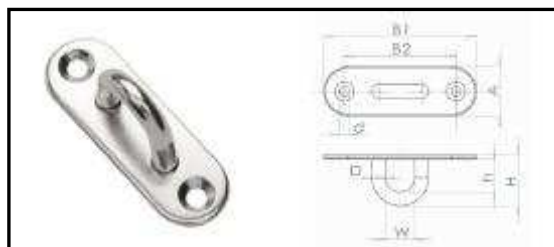

Art No.	D (MM)	A (MM)	B1 (MM)	B2 (MM)	H (MM)	h (MM)	d (MM)
SM020405	5	15	45	35.5	20	12	4.2
SM020406	6	20	60	46	25	17	5.2
SM020408	8	26	80	60	32	21	5.2
SM020409	9	32	100	73	38	26	6.5









































